

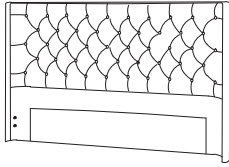

## HEADBOARD SET ASSEMBLY INSTRUCTION (TOTAL 1 BOX)

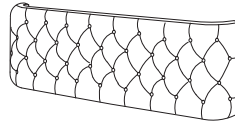

A x 1 pc



B x 1 pc

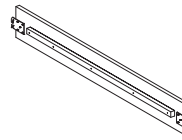

C x 2 pcs

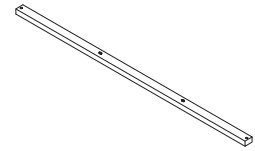

D x 4 pcs

Please read over the instructions, it will be a time-saver in the long run.

Note: Before assembly, please be sure to work on a soft flat surface to avoid any damage to the finish.

Please leave bolts loosened until all bolts are placed before tightening completely.

Part#	Picture	Description	QTY	Location	Part#	Picture	Description	QTY	Location
E		Center leg	8	Wrapped in a non-woven bag	I		Bolt Ø8x30mm	8	Already in Place
F		Legs	4	Wrapped in a non-woven bag	J		Flat Washer Ø8x25mm	8	Already in Place
G		Screws 4x50mm	8	Hardware Pack	K		Spring Washer Ø8	8	Already in Place
H		"L" Wrenches Ø5	1	Hardware Pack					

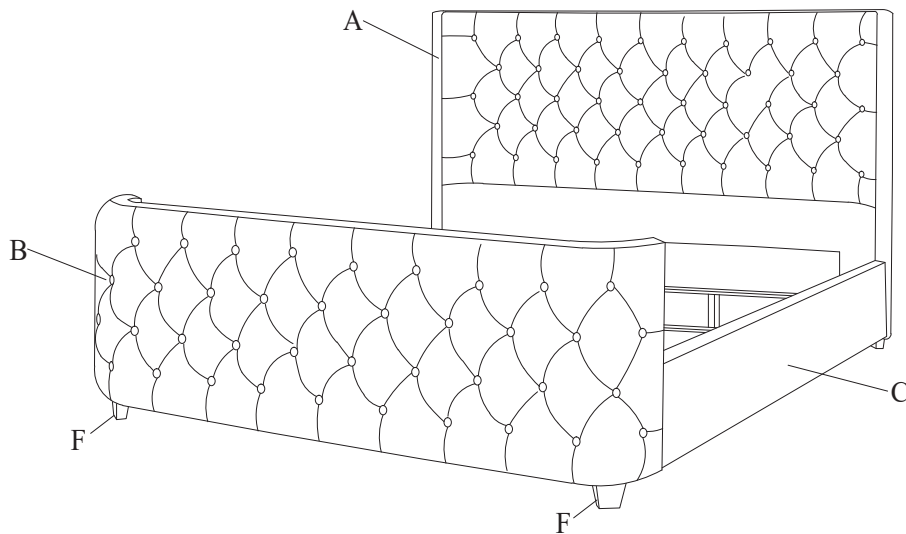

1

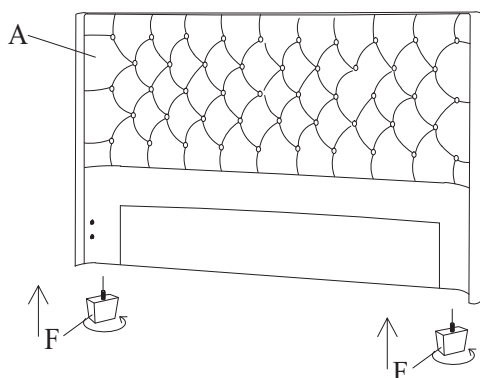

2

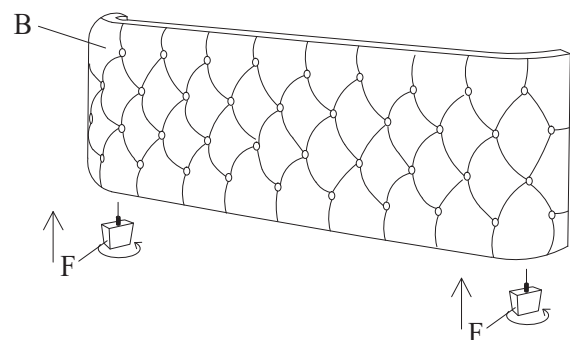

3

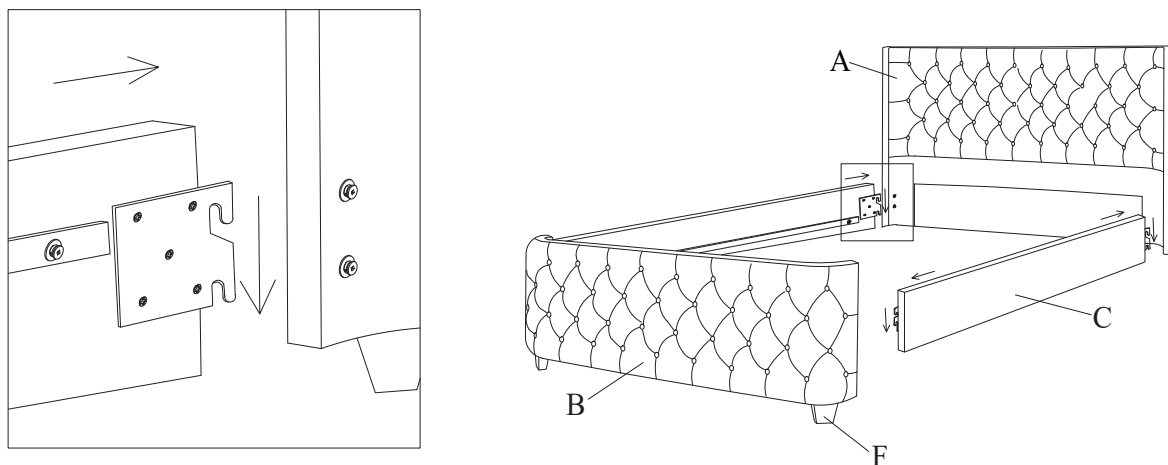

4

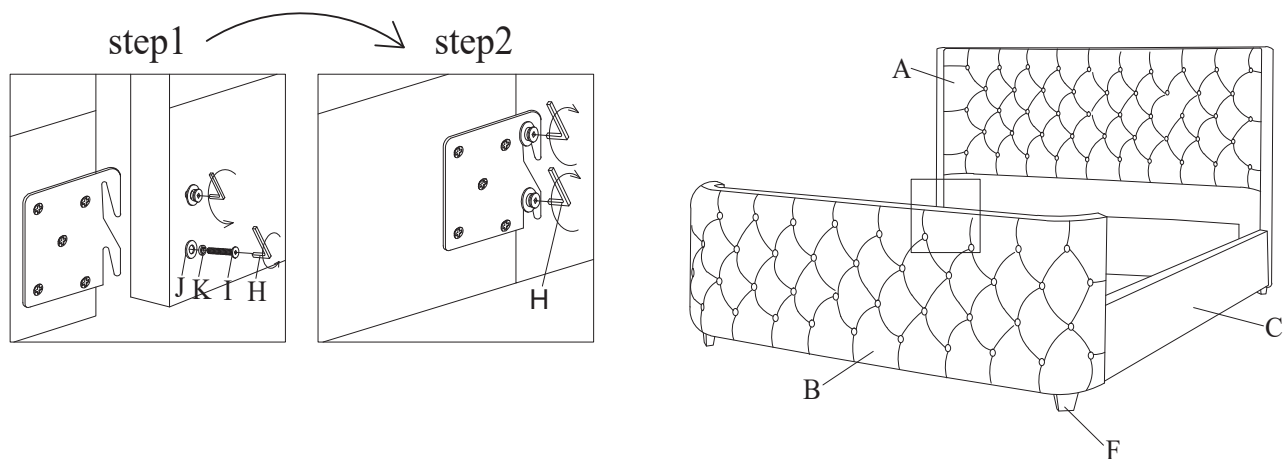

5

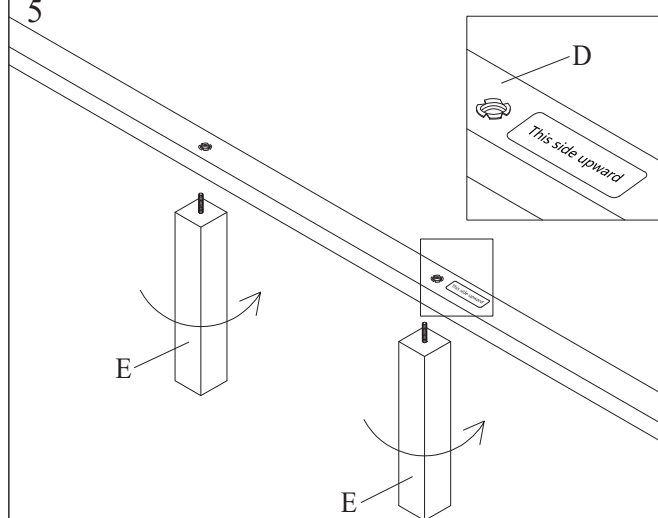

6

Screwdriver required,  
not included

