

Assembly Instructions

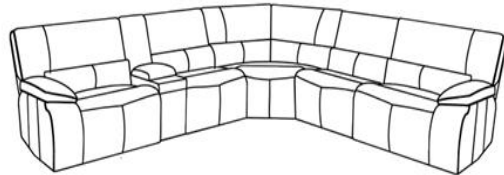

(A) Seat Cushion

(B) Left Side Back Cushion

(C) Middle Cushion

(D) Right Side Back Cushion

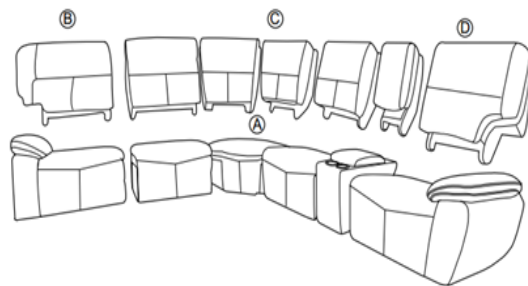

Lift seat back into position.

1

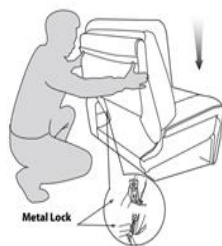

Align seat back and frame metallic quick connectors and slide into place (2,3)

2



Push down firmly on seat back to lock connectors.

3

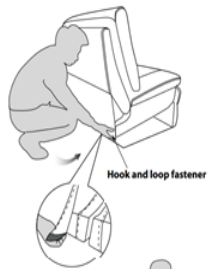

Affix back cover to bottom of the frame using the built in hook and loop fastener strip.

4

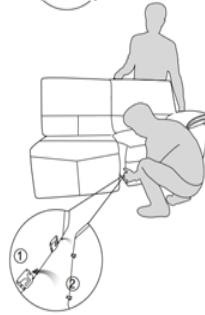

- ① Female connector
- ② Male connector

5

Put the plug into the power outlet.

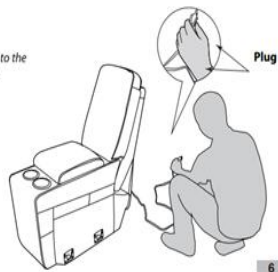

6

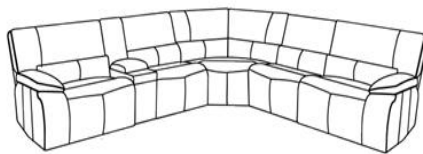

Combine the 6 pieces into a complete sectional.

7